

The Heron

Community Magazine

Delivered to homes in Christchurch, Euximoor and Tipps End

September 2023

In this issue

Car Show	2
Judds Tours	2
Community & Telephone info	3
Advertising info	4
Diary Dates	4
Editorial & Heron News	5
Letter from the Editor	5
Recreation Ground Extension	6-7
Maizing Facts	7
RAF Lakenheath	8
Michael Brookes	8
Church News	9
What's On	10
Upwell Health Centre Online	10
Townley School	11
Kids Page	12
Recipe Ideas	13
Music Quiz	13
Dog Show	13
Puzzler	14
Who Knew?	14
Club News	15-16
Magenta Doesn't Exist?	23
How Were The Fens Drained?	24



IT'S HAPPENING HERE!
CHRISTCHURCH COMMUNITY CENTRE
Friday 29th September 11.00am
through to 1.30pm.
Come along and support this worthwhile
charity. A number of our residents have
had cause to use the help of this charity in
difficult times.

Contacts: Paul and Sue Simpson
01354638730 & 07483282869
EVERYONE WELCOME!

<https://www.macmillan.org.uk>

EDITORIAL TEAM:

Editorial Team Leader - Clive Benjamin

Editorial Team: Sue Norman, Elaine Reed-Hughes, Hollie Dorward, Wendy Yates, Liz Scott

Treasurer, Advertising Manager - Elaine Reed-Hughes

Deliveries Manager - Annie Nason

Publisher - Hollie Dorward

Support—Lewis Bennett (IT), the Delivery Team and Printers

ENQUIRIES

editor@theheron.info

adverts@theheron.info Tel: 01354 638310

Tel: 01354 638088

Website: www.theheron.info



Christchurch Community Centre - Classic Vehicle & Motorbike Meeting
SUNDAY 3rd SEPTEMBER 2023 Open from 9.30 AM until Late afternoon various stalls
 and attractions in attendance (FREE ENTRY FOR ALL)



Added attraction to this event. Village dog show will be held at the rear of the recreation ground on the day

No need to Pre-book your car space just turn up. Food and refreshments available to purchase.



Find us on:
facebook®

Christchurch Community Centre, Upwell Road, Christchurch near
 Wisbech. Cambridgeshire PE14 9LL (On the Recreation
 Ground)

JUDDS TOURS AND HOLIDAYS 2023

<https://www.juddstours.co.uk/tours.html>

01945 450 210 or 01354 654 719

Stamford & Melton Mowbray

Friday 8th September

£24.00 per adult

Stamford & Melton Mowbray
 Local pick ups around Whittlesey, March & Wisbech



Christmas Mystery Trip

Sunday 3rd December

£25.00 per adult

Mystery Location Christmas Trip
 Local pick ups around Whittlesey, March & Wisbech



1940's Weekend Sheringham

Sunday 17th September

£23.00 per adult

Day Trip to The 1940's Weekend at Sheringham
 Local pick ups around Whittlesey, March & Wisbech



Thursford Christmas Spectacular

Tuesday 12th December

£68.00 per adult

Thursford Christmas Spectacular, Matinee
 Local pick ups around Whittlesey, March & Wisbech

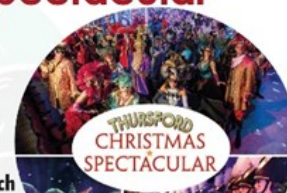

Shopping Trip to Bury St Edmunds

Wednesday 11th October

£23.00 per adult

Bury St Edmunds Day Trip
 Local pick ups around Whittlesey, March & Wisbech



Shopping Trip to Norwich

Wednesday 25th October

£23.00 per adult

Norwich Shopping Trip
 Local pick ups around Whittlesey, March & Wisbech



Community Information

Mobile Post Office:

Visits Monday to Thursday in the lay-by on Upwell Road Monday and Thursday - 16.30 to 17:00
Tuesday and Wednesday - 16.10 to 17:00
Fridays - no service.

ANYONE WISHING THEIR ITEMS TO BE POSTED,
ON THE DAY, WILL NEED TO GET THEIR POST TO THE
VAN BY 4.40PM - WHICH IS WHEN IT IS COLLECTED.

Use it or lose it!

Mobile Library:

OUR MOBILE LIBRARY COMES ONCE A MONTH, ON THE FIRST TUESDAY, AT 12.15-1.00PM.

The van parks in the lay-by on Upwell Road, opposite to the entrance of Fen View. **USE IT OR LOSE IT?**

The Mobile Library visits March, Christchurch and Manea:

March Elliot Lodge 9:30 - 10:10
March Shaftesbury Lodge 10:20 - 10:50
March Upwell Park 10:55 - 11:15
March Fleming Court 11:30 - 11:45
Christchurch Layby 12:15 - 1pm
Manea Festival Close 2pm - 3pm
Manea High Street 3:10 - 4:30pm

As well as a large range of library books, you can get your NHS hearing batteries, replacement walking stick ferrules and you can dispose of old household batteries.

You can use the Select and Collect service online, or by calling **0345 045 5225**.

https://cambridgeshire-self.achieveservice.com/service/Select_and_Collect

Please support your local Library Service, right in the heart of your community.



Please remember that no dogs are allowed on the playing field. Thank you. Your co-operation is much appreciated.

Useful Telephone Numbers

Age UK Cambridgeshire	0300 666 9860
Alzheimer's Society (Fenland)	01945 580480
Churchwarden - Mrs Helen Chappell	01354 638092
Citizens' Advice Bureau, Wisbech	03442 451292
Community Centre Bookings (Bryan)	07918 664402
Community Fire Safety Officer	07717 858166
District Councillor - Dal Roy	07885 381007
District Councillor - Matthew Summers	07725 629947
Electricity Faults - UK Power Networks	105
FACT Dial-A-Ride	01354 661234
Fenland District Council	01354 654321
Floodline	0845 988 1188
Library - March	0354 045 5225
MIND (Mental Health Crisis Line)	116 123
National Debtline	0808 808 4000
NHS	111
Norfolk Dial-a-Ride	01553 770310
Parish Clerk - David Gibbs	07932 191050
Parish Councillor - Jill Bliss	01354 638343
Parish Councillor - Ryan Feeney	07785 907509
Parish Councillor - Julia Hayes	07591 537001
Parish Councillor - James Hughes	01354 638310
Parish Councillor - Peter Owen	01354 638847
Parish Councillor - Shaun Potter	07825 016990
Parish Councillor - Andrew Sparrow	01354 638020
Police - Emergency	999
Police - Non Emergency	101
Samaritans	116 123
Telephone Preference Service	0345 070 0707
Townley School	01354 638229
Trading Standards	03454 040506
Train Information	03457 484950
Upwell Health Centre (and out of hours)	01945 773671
Upwell Health Centre - Pharmacy	01945 774934
Veterinary Centre - The Crossings	01366 382219
Water Emergencies	03457 145145

Club Contacts

Art Club - Jan Clifford	01354 638217
Book Club - Pat Rigby	07776 142642
Gardening Club - Marion Hawthorn	01354 638230
Short Mat Bowls Club - Janet Harper	01354 638681
WI - Margaret Hayes	01354 653240
Jazz Club - Cat Johnson	musiciancat@hotmail.co.uk
Christchurch Stargazers - Mark Andrews	07425 165415

Do you know someone who would like to receive a Heron each month, who doesn't live in the village?
Contact us at adverts@theheron.info and we will send them a subscription form.

The cost is £25.00 per year (including P&P).

Advertising in the Heron

Quarter Page (14cm High x 9.5cm Wide)

Portrait Format

6 x issues £52

12 x issues £92

Eighth Page (6.5cm High x 9.5cm Wide)

Landscape Format

6 x issues £36

12 x issues £66

Please contact adverts@theheron.info or phone Elaine on 01354 638310.

Advertisers - all our advert rates and conditions can be found on our website www.theheron.info. Business advertisers can book a series of 6 or 12 adverts, paid in advance. Adverts for village fundraising events, personal announcements, or small private ads are usually free.

Diary Dates

DATE	EVENT	TIME	PLACE	PAGE
Sun 3 rd	CAR SHOW	From 9.30am	CCC	2
Sun 3 rd	DOG SHOW	12 noon	CCC	13
Tues 5 th	Mobile Library	12.15pm	Lay-by (Fen View)	3
Tues 5 th	Book Club	7.30pm	Church Road	15
Mon 11 th	P C Meeting	7.30pm	CCC	6,7
Tues 12 th	Art Group	1.30-3.30pm	CCC	15
Tues 12 th	WI	7pm	CCC	16
Weds 13 th	Coffee/Lunch Break	11am-1pm	CCC	15
Sun 17 th	Church H/C	10.30am	CCC	9
Tues 19 th	Gardening Club	7pm	CCC	16
Weds 27 th	Coffee/Lunch Break	11am-1pm	CCC	15
Fri 29th	Macmillan Coffee Morning	11am-1.30pm	CCC	1
Fri 29 th	Music Quiz	7 for 7.30pm	CCC	13
Regular weekly events				
Every Mon	Short Mat Bowls	7-9pm	CCC	15
Every Tues	Christchurch Hobby and Craft Club	10.am – 1pm	CCC	15
Every Weds	Chair-based exercise class Kathleen Henderson	10-10.50am 07880 543821	CCC	
Every Thurs	Coffee, Cake & Chat	2-3pm	CCC	9
M, T, W, TH	Mobile Post Office	Various	Near Lay-by (Fen View)	3
SAVE THE DATE!				
Sun Oct 1st	Welle Cinema: screening "A MAN CALLED OTTO"			
Sat Oct 7th	HARVEST SUPPER	6.30pm	CCC	9

At the time of going to press, all information is as accurate and up to date as we can make it. Changes and updates may be published subsequently. All information contributed by outside agencies, including dates etc., will be assumed to be correct.

NB as a matter of courtesy no content from the Heron should be used without prior permission.

Editorial

Welcome to our September edition. My favourite season is Autumn, and September is blooming in our area. And so many berries on the trees and bushes in our area! Beautiful.

All best wishes to the children and young people going back to school this month or to a new school ...or college, or university. Exciting times. Don't forget to talk like a Pirate on September 19th, whatever age you are (-: (p 12).

Are you new to the village? You may have noticed that we often have some noisy aeroplanes flying over Christchurch! Andy Lansdell, a resident, is very knowledgeable about these aircrafts, and is an enthusiast. He has written about some of them on p 8. He plans to do another article next month too. Thanks, Andy.

Lots of things to do this month (What's On? P10 and Diary Dates). Have a great September, all!
Annie Nason

Heron News

Our new Editor, Clive Benjamin, is in place. He will be overseeing his first edition, which is the October Heron.

DID YOU KNOW?

- The Executive Committee meets about 3 times a year and they plan fundraising events. The next one is the Musical Quiz evening on Friday September 29th. (p 13). Come along and support us!
- The Editorial Team meet very early in every month to review the current Heron, and to plan the next month's edition. That's quite a commitment.

A Letter From the Editor



Dear Everyone,

This is just to say a fond "goodbye" as the September issue of The Heron is my last one as Editor. It's been a fun ride, working with a great

team. I couldn't – wouldn't – have done it without their support. Here's hoping our readers have also enjoyed the ride. You will be pleased to know that the new Editor, Clive Benjamin, can both spell, and do maths, unlike me! Our proofreaders will be relieved, doubtless.

And contrary to earlier speculation by some folks, I won't be closing down the laptop. Instead, I have a project to complete to do with the social history of the development of the Anglican Church in N-W Burma (now known as Myanmar), the country where I was brought up. My parents were Christian Missionaries there and I have loads of photos and papers to look through. This is in connection with the Birmingham

University Special Missionary Archives Department, which already has my father's Missionary Journal 1932 - 1965. I need to get on with this! Also, I will still be supporting The Heron in other ways...writing some articles if required, and still being the Heron Delivery Manager.

Thank you to everyone for your support for The Heron. Keep it up! It's a great magazine. And a big thank you to the team for the lovely flowers and very generous Garden Token as my leaving present. Such a surprise! There was no need, but I was delighted.

Every blessing to all and to The Heron. It's in very capable hands and will go from strength to strength, I know. BTW ...the editor@theheron.info email address will now automatically find our new Editor, Clive. Thank you to Lewis Bennett for working his magic to achieve this. Brilliant.

Copy Deadline - The deadline for copy for the October edition of the Heron is 22nd September

Letters to the Editorial Team

The Editorial team welcome letters from its readers. Please email letters to: editor@heron.info or post them to *The Editor of The Heron, Grasshopper Cottage, 5 Upwell Road, Christchurch, PE14 9LF.*

PLEASE NOTE: Letters will only be considered for publication if they are accompanied by name and contact details. The Heron will not share any contact details unless given permission.

The team look forward to hearing from you!

Christchurch recreation ground extension – or the new field project.

So, as promised by Annie in the PC snippets last month, here is some more detail about the new field project.

For those who don't know, the project has come about because the Parish Council have re-acquired the land to the side of the existing recreation ground - on the far side of the drainage ditch that runs alongside the length of the existing rec. The area this field covers is approximately 200 metres by 50 metres. To put these dimensions in a bit more context this is almost twice the length of a professional football pitch and slightly narrower.

The brief for the area was a bit loose to start with, but it was stated that the area should be accessible to all members and groups of the community. One of the clearer intents was that the field should provide a free area for dog owners to exercise their dogs off the lead, as the existing recreation ground is a dog-free area and most dog walks take the form of three routes out of, and back into, the village.

Creating a new recreational facility for the village is a challenge, but one that is both exciting and daunting at the same time. In January, meetings were held to gauge public interest, and from that a steering group was formed, to put together a more detailed plan of action.

You may think, looking at the field in its present condition, that nothing has happened since then; except that the weeds have had a readymade environment in which to flourish (thistles and poppies have been particularly rampant this year, making the most of their free reign). However, work has been going on behind the scenes on different fronts. Practically, in late January – on a particularly frosty and foggy morning (so foggy in fact that you couldn't see from one end of the field to the other!) debris that had come from the ditches during clearing was moved into manageable piles for later removal. Following this, in February and March over two Sunday mornings, volunteers planted 400 hedging and tree saplings which had arrived in two batches. 400 plants and saplings may sound a lot, but in reality, these have so far only contributed to a row of border hedging adjacent to the farmed field next door that is about 50 metres long. So, plenty still to do here! When the second batch of saplings arrived, it contained some larger trees – oaks, ash, rowan, silver birch etc. so these were heeled in to be moved at a later date when the planting schedule is more defined.

The members of the steering group are Simon Freeland (Chair), Clive Benjamin, James Hughes, Liz Scott, Andy Streets, and myself. Simon has enthusiastically come up with the overall plan for the layout of the new space. Liz has been dealing with fundraising and the rest of us have been researching different elements, getting costings and arranging quotes for work. At present no formal name has been settled on the project. There have been various suggestions – Eco Park, Queen

Elizabeth Memorial Park, Coronation Park; even a tongue-in-cheek suggestion of Parky McParkface, but nothing concrete so far. Simon has been very keen to incorporate as much as possible to make the design of the park area as inclusive as it can be for all members of the local community.

The plan that has evolved allows for a fenced-off area that dog walkers can use and allow their dogs off lead to run freely. This is an area approximately 50 metres in length and poo bins will be provided! There is also an orchard area which will have a wheelchair accessible pathway winding through. Once the various fruit trees here mature, produce from these will be free for anyone to take. There will be a range of fruit trees – apples, pears, plums and the like, specifically chosen as varieties native to Cambridgeshire.

Further works in the centre of the field will consist of a raised, or banked, circular area to create an amphitheatre where local groups can hold and host events – possibly concerts or theatre productions. The amphitheatre will be created from the spoil taken to produce the Eco Pond, an area created to encourage wildlife and pond life and somewhere that the school can use to study biodiversity. In amongst the grounds, bat boxes and bird nesting boxes will be placed to encourage further wildlife diversity. As the only access to the field at the moment is via Upwell Road, additional pedestrian access points will be created with bridges from the existing recreation ground and Crown Drove.

There are no two ways about it, this is an ambitious project. It really is not easy trying to produce something that is pleasing to all and something that is 'future-proofed'. Unfortunately, not all of the work will be able to be completed at once, so the plan is to phase the works over the coming years.

As ever these days money to fund this type of work is always an issue, especially in a small community. The Parish Council has earmarked a small amount of funding towards the project this year – none of which has been spent so far, as all work undertaken has been on a voluntary basis and all plants have been donated by the Woodland Trust. Liz has worked tirelessly on the wording and technicalities needed for a funding application to Whitemills. It is hoped that there will be some news about the success (fingers crossed) of the application soon.

If successful the Whitemills and PC funding will allow the first phase of the works to commence. This will include the first footbridge from Crown Drove being placed, clearing and levelling the field, grass seeding at least the first third of the field – the Crown drove end, fencing off the dog walking area and preparing the orchard. Further donations of hedging plants have been secured from the Woodland Trust already for these works. Future phases of work will depend on continued funding, but it is anticipated that these will be able to include the digging of the pond, the construction of the

amphitheatre and the addition of the second bridge linking the existing recreation ground.

So, what can you do to help? Well volunteers are going to be needed to help clear and plant (even if it's just an hour of your time to plant a dozen saplings). Local groups can apply to the Woodland Trust for trees and hedging plants. Any offer of equipment or labour to help with ploughing, ground preparation and seeding would be greatly appreciated. Any suggestions as to streams of finance that could be tapped into would also help. Do you work for an employer who has funding available for local projects, or who can supply building, fencing or other materials? It is hoped that we can set up some

sort of crowdfunding in the future and we are looking to offer the opportunity for individuals or families to be able to sponsor, or donate to, specific parts of the park - for example memorial trees or benches. All suggestions or donations will be gratefully received. We will keep you updated on the progress of the project in future issues.

Shaun Potter

(The plan of the new field project is shown in the Parish council annual report which came with the Heron last month. I have a few spares if you need one). Annie Nason

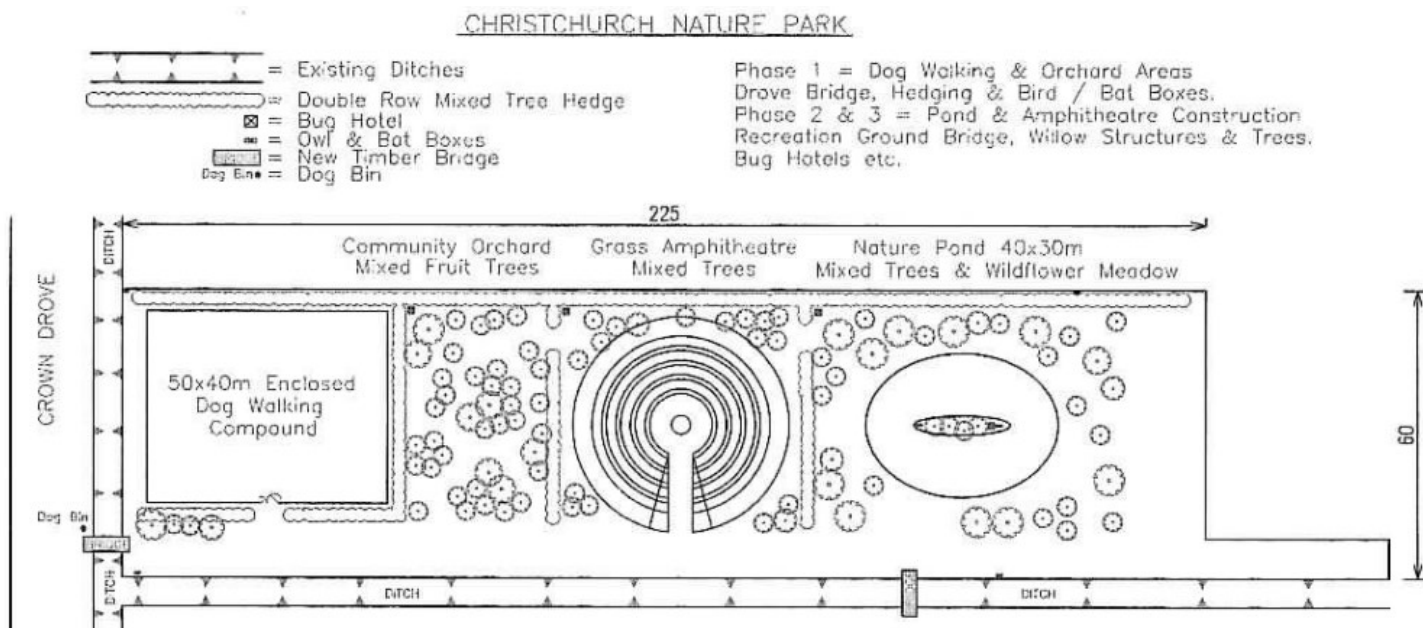

Maizing Facts...



How many of you have done the Maize at Skylark? Next time, just think about this - *Is maize a vegetable, grain or fruit?*

Maize, otherwise known as corn, is actually all three of these things. It is a starchy vegetable similar to potatoes, but its kernels can be milled for flour, making it a grain. It is also a fruit, because the ears develop from the flower of the plant.

The world record for the height of the plant currently stands at over 48 feet! Corn has an even number of rows on each ear. Most varieties have between 8 and 20 rows of kernels and come in a variety of colours dependant on where it is being grown, and its purpose. Clothes are produced from calico, possibly the second most common variety. In East Africa, porridge made from maize is called ugali, whilst here we consume a vast number of cornflakes. The crop is also used in the manufacture of fireworks, glue and paint as well as plastics and penicillin.

Amongst other uses, maize is used in animal feed, and increasingly as a biofuel. These two uses account for two thirds of maize grown in the USA. In Peru a variety of corn that has large kernels is grown where kernels are eaten individually. Maize feeds the world, but makes populations vulnerable because, if a crop fails, or is destroyed in any way, there is often no substitute that can be relied on.

Corn is also used in the newer biodegradable packing materials, and fermented to produce alcohol. As a crop, it is also very hard on the soil, meaning fields have to be rested between crops or nutrients added back into the soil before the next planting.

So, as you sit down to watch the New Year's fireworks, with popcorn in hand, which is clearly packaged in a biodegradable material, thank the god of maize who loses his head at the start of every harvest, for the success of every crop in all of its shapes and colours.

Liz Scott

Photo: This year's Maize Maze design. Photo by Teddy Harris. www.skylarkgardencentre.co.uk PS – Did you know? Corn (maize), rice, buckwheat, sorghum, amaranth, millet and soy are all gluten-free grains. However, barley, wheat, rye, couscous and semolina contain gluten. Ed.

RAF Lakenheath

F-15-E's lined up on the "First & last" being checked out before another Sortie

RAF Lakenheath was originally known as Lakenheath Warren. During WWI it was used by the RFC (Royal Flying Corps). During WWII, it was built as a decoy airfield for the nearby RAF Mildenhall. In 1946, at the beginning of the Cold War, the USAF (United States Air Force) took over the base, moving in B-29 Bombers. It has stayed in USAF hands ever since then. Today's Current Tenants are "The 48th Tactical Fighter Wing", also known as "The Liberty Wing". They are made up of the following:

- 492nd FS (Fighter Squadron), Nicknamed "The Bolars", flying F-15E Strike Eagles 2 seat Fighter Bomber Aircraft.
- The 494th FS, nicknamed "The Panthers", again flying F-15E Strike Eagles.
- 495th FS The Nicknamed Valkyries, flying the new F-35A Lightning II Single Seat Multi Role Fighters.
- The 493rd FS was Inactivated in 2022, back to the USA, but is starting to be re-activated with the F-35A Multi-Role Fighter

These are the most common types of Military aircraft seen over-flying Christchurch. There is a free aircraft viewing area at RAF Lakenheath, on Brandon Road. It can get busy at times and I would recommend Ear Protection for young ones. From Monday to Thursday there is a Burger Bar on site, where Dave does the BEST bacon roll!

If you need any further information about the base, how to get there etc, you can find me on Facebook, where you can PM me any questions. If you see me out and



about the village, with or without my camera, please stop me and ask...

I will (hopefully) continue this mini-series in next month's Heron with a brief History of another USAF Base, this Time RAF Mildenhall. **Andy Lansdell**



A F-35A Of 495th FS "The Valkyries"



A Mix Of 492nd (Bolars) & 494th FS (Panthers) Being readied for flight on one of the pans.

Obituary

Michael Peter Brookes 20/07/1972 – 04/06/2023



It is with great sadness that I have to announce the passing of Michael Peter Brookes. Michael was well loved by many people and was heavily involved with many different communities. Son of Peter and Helen

Brookes, brother to John, Ray, Anne and Christine and uncle to Lilith, Michael, Ruby, Kian and Seren.

He was a strong supporter of Special Effect charity and also The German Shepherd Welfare Fund, from where he adopted his own beloved "housewolf" Wellington. A very sad day but it was lovely to see so many people attend. The guest of honour would have to be Wellington, who the German Shepherd Welfare Fund brought. I cannot express how grateful we are for you to bring him, and he was just so amazing...thank you so much ♥.

Many thanks to all of Michael's friends and extended family who attended Michael's funeral, and for the Dun Cow for hosting the wake. Many thanks for the donations that were given to his two favourite charities.

Christine Brookes.

August 2nd was the occasion of Michael Brookes' Funeral. Who recognises this guest? Michael's Rescue Dog, Wellie, of course.

"A special guest turned up for Michael today. He looked really well and sat down in the pub with his favourite packet of Pork Scratchings". (Paul Simpson)



Church News

Services in the Benefice

All services are at 10:30am unless otherwise stated.

3rd September - Doddington - Holy Communion

10th September - Manea - Holy Communion
Wimblington - Morning Prayer
Benwick - Evening Prayer - 3pm

17th September - Christchurch - Holy Communion
Doddington - Harvest Service

24th September - Manea - Harvest Service
Welney - Harvest Service - 4pm
Wimblington - Holy Communion

A Thought for September

Do you harbour grudges? Can you remember word for word arguments you had years ago? I know I do.

One of our readings in church this month is The Parable of The Unmerciful Servant. It is all about forgiveness (Matthew 18: 21-35). As Christians, we know that we have been forgiven by God for all the things we have got wrong and all the mistakes we haven't yet made. In return, we should forgive people who have caused us upset.

I find the idea of forgiveness really difficult. Can I forgive the person who crashed into my car? Can I forgive my teenage son who keeps getting into trouble at school? Can I forgive the employer who makes my working life miserable?

In the parable, the unmerciful servant is punished for being unforgiving.

How does it feel when you harbour a grudge? How does it feel to rerun arguments in your head? Is this the punishment for being unforgiving?

Cake, Coffee and Chat

We meet every Thursday in Christchurch Community Centre 2-3pm. All welcome.



Christchurch Parish Church Harvest Supper

Saturday 7th October 2023
Christchurch Community Centre
6:30pm

Two course meal
A grazing platter of meats, cheese and quiche
with new potatoes and salad
and a selection of desserts

Followed by entertainment with
Rhiannon Rae



Adults - £12.50
Children Under 11 - £5

Thank You

On behalf of the PCC and congregation, I would like to thank three families and a club in the local community who have between them donated a huge total of £893. We are so very grateful for your kind generosity.

We have been holding fundraising events for a year now and, including donations, we have raised £5702.64. We are currently waiting to hear from The National Churches Trust, and C and G Trust regarding grant applications we have made to them. Thank you to all who continue to support us.

Helen

Looking for somewhere to go?

What's on in September 2023

3rd September Sunday, 11.00am- 5.30pm: March Armed Forces Fair, West End Park, March. PE15 8DW. Military vehicles and displays. Armed Force's Organisations, Brass and Military bands, stalls, classic cars and Land Rovers. Free Entry.

3rd and 17th September, 11.00am -2.00pm: Lakes End 'Late Risers Car Boot Sale' at Lakes End Village Hall, Postcode PE14 9QP. This is a new car boot sale just starting up. Sellers £5 per vehicle (up to van size) Buyers free entry. Sellers set up from 10.00 am.

8th September, Friday - 2-4 pm: Tea Dance at Queen Mary Centre, Queens Road, Wisbech PE13 2PE. Free community event; learn some steps with dance instructor, dance the afternoon away with Ballroom, Latin, Sequence and Party Dances. It doesn't matter whether you are a dancer, tea drinker, or want to learn some dances. No partner? Buddy up with someone! Call 07874 893316 to book your place. Tea and nibbles provided.

9th & 10th September, Saturday and Sunday 9.00am-5.00pm: Sandringham Game and Country Fair, West Newton, Kings Lynn PE35 6EN. Falconry, Gundogs, Horse Boarding, Scurry Driving, Ferret Racing, Have-a-Go events, Clay Shooting, Archery, plus craft stalls, glass blowing, wood turners and blacksmith demos. Fun Fair. Adults £18 Child (5-15) £6

9th & 10th September, Saturday and Sunday 9.00am- 5.00pm: 48th Haddenham Steam Rally and Heavy Horse Show. A1421, Sutton Road, Haddenham, Ely CB6 3PT. Traditional steam and country fair; steam engines, vintage lorries, tractors and cars. Adults £12.50 Children Free (if under 16 and accompanied by a paying adult). If disabled and bringing a carer, pay entry fee and carer gets in free; follow signs to disabled car park. Dogs welcome but must be kept on a lead.

10th September, Sunday 2.00pm: Heritage Open Day at Stonea Camp, Manea Road, Wimblington (almost opposite Skylark Garden Centre). An afternoon of discovery to find out how it was developed during the Neolithic Age and built on over time, to become a defence and spiritual site for Boudicca's Iceni tribe during the late Iron Age. Free Entry.

23rd September, Sunday 7.30pm: Ely Cathedral. ELY SINFONIA Concert. Ravel, Gershwin, Saint-Seans. Tickets from £10. Ely Cathedral Box Office. 01353-660349
box.office@elycathedral.org www.elycathedral.org/events

24th September, Sunday Set Up 10.30 Buyers entry 11.00. Horse Tack Sale, Upwell Playing Field PE14 9AB. £5 per pitch. Toilets and refreshments will be available.

Point of View

When the
power of *love*
overcomes the
LOVE OF POWER,
the WORLD will know
PEACE
Jimi Hendrix



Upwell Health Centre Contact Us Online! Here's How.

-  For prescription requests, please go to <https://ow.ly/6lcu50Pq3tX>
-  Register with us - <https://ow.ly/Or8p50Pq3tW>

We are delighted to provide you with convenient online options to connect with our practice. We understand the importance of accessibility and want to ensure you have a seamless experience.

By utilising our online options, you can save time and access our services from the comfort of your own home. However, please note that these channels are best suited for non-urgent matters. For out-of-hours medical emergencies or urgent concerns, please call NHS 111.

We are committed to providing you with excellent care and prompt responses to your inquiries. Rest assured that our team will address your messages as soon as possible during our regular office hours.

Thank you for embracing our online communication channels! We appreciate your cooperation and look forward to serving you efficiently and effectively.

#ContactUsOnline #ConvenientCommunication



TOWNLEY SCHOOL AND NURSERY

Christchurch, Wisbech, Cambs. PE14 9NA
office@townley.cambs.sch.uk
Website: www.townley.cambs.sch.uk
01354 638229



Facebook—Townley School and Pre-School

Remember that our website has lots more information about school.

August 2023

This school year has gone by so quickly. We have been busy as a school, introducing Forest School across the whole school, as well as all the other areas of the curriculum. This is our second year of following Curriculum of Unity School Partnership (CUSP) and we are really seeing the benefits this is bringing to the outcomes for the children, especially in reading (hence our SATS results were 84%, when nationally they were only 73%). This Year 6 have been an amazing group of children. They have worked and played hard. They have embraced our Townley values of kindness and inclusion. We wish them every success as they move to their secondary schools.

There are so many people who I would like to thank for their support this year -

- FOTS, who make everything special for the children; they have been relentless in fundraising this year. They couldn't do it without them.
- The Governors, who give their time freely to be a critical friend of the school, especially Mrs Rudge, who gives the children so much more time by coming in to support Hawker with reading and swimming, and Mrs Bayliss who has worked her socks off to become a Forest School Leader in her own time to support the children.
- The staff, who go over and above to ensure your children receive the very best they can.
- Sharon for all her support with ensuring the children are never hungry and the special meal today.
- The volunteers this year; we couldn't do it without you. (If you are reading this and would like to volunteer, please get in touch with us).
- Our school community, parents, carers, extended family and all of the residents of the villages we serve who read these articles and respond to our requests.
- Lastly our children. I feel like they are ours too! The children are amazing; they are kind, inclusive and make us proud every day.



Photographs are from the Y6 leavers treat trip, Miss Saward organised a trip to Flip Out, and their end of term performance of Alice in Wonderland (our most ambitious yet!).

Kids Corner

AHOY LANDLUBBERS!

ARRRRRRRRRRRRGH!

**WHAT'S SPECIAL ABOUT SEPTEMBER 19TH?
IT'S INTERNATIONAL TALK LIKE A PIRATE DAY !**



International Talk Like a Pirate Day is a parodic (making fun of) holiday created in 1995 by John Baur and Mark Summers of Albany, Oregon, USA, who proclaimed September 19th each year as the day when everyone in the world should talk like a pirate. It has since been adopted by the ****Pastafarianism** movement as an official holiday.

"Cap'n Slappy" and "Ol' Chumbucket", were the founders of *Talk Like a Pirate Day*. The holiday resulted from a sports injury. During a racquetball game between Summers and Baur, one of them, in pain, said, "Aaarr!" and the idea was born. The game took place on June 6th, 1995, but out of respect for the observance of the



Normandy landings (same date), they chose Summers' ex-wife's birthday, as it would be easy for him to remember.

At first an inside joke between two friends, the holiday gained exposure when Baur and Summers sent a letter about their invented holiday to the American syndicated humour columnist Dave Barry in 2002. Barry liked the idea and promoted the day, and later appeared in a cameo in their "Drunken Sailor" Sing Along A-Go-Go video. Michigan folk musician Tom Smith wrote the original "Talk Like a Pirate Day" song in 2003.

**** PASTAFARIANISM:** *The central belief is that an invisible and undetectable Flying Spaghetti Monster created the universe. Pirates are revered as the original Pastafarians. Henderson asserts that a decline in the number of pirates over the years is the cause of global warming. HAHHAHA*



See how many of these Pirate words you can use in conversations on September 19th!
Ahoy matey, Shiver-me-timbers, Walk the plank, adventure, ahoy, anchor, ashore, attack, aye-aye, barrel, booty, bounty, buccaneer, cannon, captain, capture, cargo, coins, compass, crew, deck hands, eye patch, first mate, galleon, gangplank, gold, gunpowder, high seas, jewels, keel, land-ho, landlubber, Long John Silver, Peg leg,

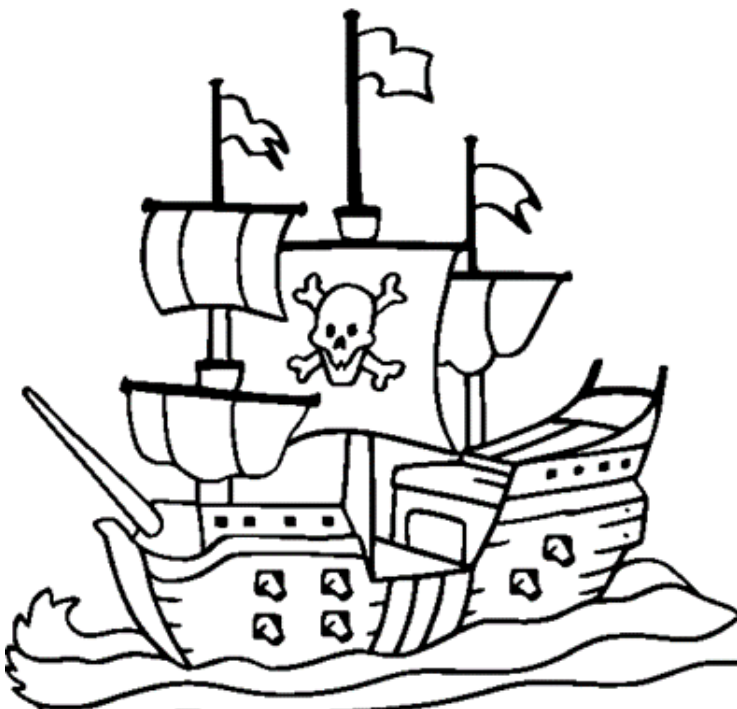

A Couple of September Bs...

Brussels Sprouts - Love them or loathe them, September marks the start of Brussels sprouts season. There are so many ways to cook with Brussels sprouts beyond a simple steam: when grilled or fried they take on a delicious caramelised flavour while still retaining their texture.

Christmas dinner isn't complete without Brussels sprouts, but it's safe to say they're not always the most popular food on the festive table. But that might be because you're cooking them all wrong.

The key is to avoid boiling them at all costs! This just makes them soggy and waterlogged, which compromises the flavour and makes them the least popular side on anyone's plate. Instead, steam them so that they retain their delicious crunchy consistency or stir-fry/roast them to impart some extra flavourings. Some classic flavours to pair with your sprouts are maple syrup and bacon, or pomegranate and blue cheese.

We also love to shred our sprouts, stir-fry them to get them lightly crispy and golden, and then top them with lashings of Parmesan. Alternatively, for a more hands-off recipe, you could serve your Brussels sprouts in a gratin with a cheese and cranberry sauce.



Runner Beans - A veg garden staple, runner beans are easy to grow and produce a generous crop to enjoy throughout September. The easiest way to cook runner beans is to bring a pan of water to the boil, then cook the prepared beans in the water for 3-4min (larger, older beans will require longer cooking). Drain the beans and rinse under cold water to stop them over cooking and going mushy.

You can then warm them through, season and serve buttered as a side, toss with other ingredients to make a warm salad, or you can use them in a dish such as a summery pasta or risotto.

Runner beans can also be steamed for 4-5min and used in the same way. Alternatively, you can stir fry them in hot oil for 2-3min.

Source: <https://www.goodhousekeeping.com/uk/food>

Music Themed Quiz

Friday 29th September 2023

Christchurch Community Centre, Upwell Road, PE14 9LL

Doors open at 7 for a 7.30pm start.

Teams of no more than 6
£2.50 per person.

Licensed bar - feel free to bring your own nibbles.

Raffle at half time.

Music Trivia
Pop Master
Beat the Intro

To register your team please call or text 07904 462023 .

CHRISTCHURCH FUN DOG SHOW Have a go fun Agility

By very kind permission of the
Hall Committee

Sunday 3rd September

12 o'clock start - Pay in the ring - £2

Rosettes & prizes 1st - 6th

- 1) Minor Puppy (3-5 months)
- 2) Pedigree Puppy (6-12 months)
- 3) Xbreed Puppy (6-12 months)

Best Puppy in Show

- 4) Toy / Utility / Terrier
- 5) Gundog / Hound
- 6) Working / Pastoral
- 7) Prettiest Bitch
- 8) Handsomest Dog
- 9) Young Handler (Under 16)
- 10) Adult Handler
- 11) Veteran 7yrs +
- 12) Best Rescue
- 13) Best Trick
- 14) Best Sausage Catcher

20 minute interval

Best in Show & Reserve in Show (Winner of Classes 4-14)

In conjunction with Christchurch Car Show
Food Drink Bar Parking
Childrens Play Area - lots & lots

The organisers are not responsible for any injury, accident or damage to people, animals or property

All DOGS must be on leads at all times

No Bitches in Season

Info call Jackie 07477974358

Puzzler

1 Which pins need to be knocked over to make exactly 100?



2 Which numbers should replace the ??????



3 Archie lied on Mondays, Tuesdays, and Wednesdays, but told the truth every other day of the week.
Kent lied on Thursdays, Fridays, and Saturdays, but told the truth every other day of the week.
Archie: I lied yesterday.
Kent: I lied yesterday, too.
What day of the week was yesterday?

4 Every Friday, Tim visits his favourite coffee shop. Each month, he visits the coffee shop 4 times. But some months have more Fridays than others, and Tim visits the coffee shop more often. What is the maximum number of months like this in a year?

Answers on page 17



Who knew?

These familiar companies all have non-British owners.
It's a very small world...

- ! Holland & Barrett's owned by Russians
- ! Natures Best owned by Merck KGaA (Big Pharma) Germany
- ! Seven Seas Cod Liver Oil owned by Germans (Merck KGaA)
- ! British Airways owned by the Spanish
- ! Heathrow Airport now owned by the Spanish 25%, and Qatar 20%
- ! Cadburys Chocolate owned by the USA.
- ! P&O Cruises owned by the USA
- ! Rolls Royce owned by Germans (BMW)
- ! Selfridges owned by Canadians
- ! Tetley Tea owned by Indians
- ! Imperial Chemical Industries (Dulux) owned by the Dutch
- ! Walkers Crisps owned by USA
- ! Lea & Perrins Worcestershire Sauce owned by USA
- ! Jaffa Cakes owned by Turkey
- ! Harvey Nichols owned by Hong Kong
- ! Kit Kat owned by the Swiss
- ! The Financial Times newspaper is owned by Japan
- ! Marmite is owned by the Dutch
- ! Walls Ice Cream is Dutch owned as well
- ! Hartley's Jam owned by USA
- ! Most Premier League football teams have foreign owners
- ! Hamleys is owned by China

- Waterstones is owned by USA
- Innocent drinks are USA owned
- Scottish Power is owned by Spain
- Thames Water is German/Omers (Canada).
- Pilkington Glass is owned by Japan
- Abbey National is owned by Spain
- Newcastle Brown Ale owned by the Dutch & Danish, and even brewed in Holland.
- Beefeater Dry Gin owned by France
- Harrods owned by the state of Qatar
- The Mini is owned by Germany



Coffee/Lunch Break



By popular request, Lunch Break is changing its times.

Come over for a coffee; bring your lunch as usual; just come for a chat...

Always the 2nd and 4th Wednesdays of the month.
Coffee/Lunch Break this month – 13th and 27th – 11 am - 1 pm, in the Community Centre. (A warm space!)

IT'S FREE! Everyone welcome.

Contact: Annie on 01354-638088

Indoor Short Mat Bowls



Club meeting every Monday 7-9pm at Christchurch Community Centre.

ALL WELCOME! (Spare bowls available to loan.)

For further details call Janet Harper on 07941 465319.

Christchurch Hobby and Craft Club

**Every Tuesday
10.00 AM- 1.00 PM
Christchurch Community Centre**

Bring your art, craft or hobby along to the club to work on and share with like-minded friends.

Maybe you will introduce us to something new or find something you would like to try, i.e. artwork, needlework, crochet, card making, Lego, or maybe there is a jigsaw puzzle looking for someone to finish while you are thinking of what to start.

Interested?

Contact Janet Harper on 07941 465319 or Pat Rigby on 07776 142642

Christchurch Art Group



We meet on the 2nd and 4th Tuesday of the month 1.30-3.30 in the Village Hall (term time).

- Our focus is to explore and experiment with the various painting and drawing media
- To enable participants to develop their own style
- Above all to have fun and enjoy the sessions
- The sessions are planned and adjusted to suit, depending on the experience and interests of the group
- The group leader is experienced in a wide range of media, and has some art materials for you to try out if they are new to you. *We have suitable paper for a reasonable cost to purchase and materials can be borrowed until you have your own*. Our group is friendly and relaxed and we love to welcome new folk.



If you would like a programme, please contact Jan and one will be sent with any further information.

Please contact Sandra 01354 638478 or Jan 01354 638217. (clifford.jjr5846@gmail.com)

Christchurch Book Club



Christchurch Book Club met in August to discuss the last book 'No One Home', by Tim Weaver.

The book tells the story of an investigator hired by families whose parents disappeared on Halloween from the tiny Yorkshire village of Black Gale, along with everyone else living there. In Los Angeles, a detective is investigating a murder, and the book flits between both countries to discover how the villagers' disappearance, and what happened in Los Angeles, are linked. The Book Club really enjoyed the book. We do like a good thriller!

The next meeting will take place on Tuesday 5th September, hosted by Pat Rigby, where we will discuss the current book, 'The Nanny', by Gilly Macmillan.

The next book, for September, is 'The Familiars', by Stacey Halls.

New members are always welcome. For further details or if you would like to come along to one of our meetings, please contact Pat Rigby on 07776 142642.

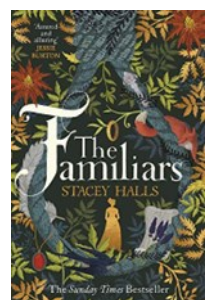



Our speaker on August 8th was Mark Mooney, and he is an enthusiast when it comes to Bonsai! He brought along at least 25 examples of these small but perfect trees to illustrate his talk. Mark spoke about the fascinating history of Bonsai, from its origins in China, and its spread to Japan. Vietnam also has a history of Bonsai. Each heritage has a different style.

Did you know Bonsai should be kept outdoors, not in the house? All they need is air, water and some nutrients occasionally. Root trimming should only happen every few years. What a fascinating hobby! Thank you to Mark.

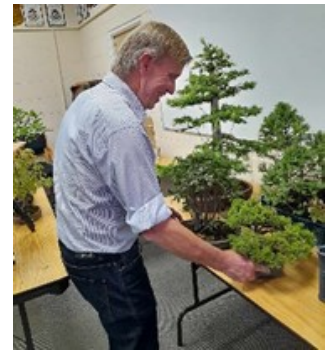

MEMBERS: Our next meeting is on **September 12th, 7pm.** A Harvest Supper, prepared by the committee. Please let Margaret Hayes know if you are coming. Bring along any extra garden produce to share, and bring

memories of Harvest times past.

Raffle Prizes: Jane D and Linda J.

Refreshments: Ginny M and Helen C. No need to bring milk etc as they will be provided each month by committee members Linda and Ginny.

NEW POLICY: Members - please bring £5 to cover the cost of refreshments etc until March 2024.



Christchurch WI Open Meetings

Christchurch Community Centre PE14
9LL

All start at 7pm

Tuesday October 10th 2023

Flower Demonstration by Ann Purt

Tuesday November 14th 2023

Christmas Craft Demonstration by Penny Hicks

Tuesday December 12th 2023

Musical Evening with Upwood Ukulele Group

Entry cost for all - £5.00

Including Light Refreshments and a raffle ticket.
More raffle tickets available to purchase.

***WI Open Meetings are always open to both men and women
who would like to come along***

We look forward to seeing you!

Christchurch Gardening Club



Hydroponics

The club's regular monthly meeting at the Community Centre, played host in August to local gardener Gerry Wilmott. Gerry kept the members' interest, explaining the basic principles of Hydroponics as used both commercially, and in his own greenhouse. Hydroponics is the science of growing plants without using soil, by feeding them on mineral nutrient salts dissolved in water. While commercial growers will tend to use free flowing water from a stream (preferably one containing trout, whose waste products act like fertilizer), Gerry has a more readily available approach.

Using a garden automatic watering system, with pots raised up on legs, the water will sit in a tray and be supplied to the plants using a wicking cord. This method, we are assured, produces healthier plants with a better root system, and judging by the size of Gerry's cucumbers seems to work. An interesting approach to growing in a greenhouse.

Next month we will welcome to our meeting Mr Michael Croot who will be talking about commercial growing. He has promised to bring along lots of samples so not a meeting to be missed.

FYI the club meets at the Christchurch Community Centre on the third Tuesday of each month. Please call 01354638230 for details, or come along on the night. We will be happy to welcome you.

Steve

IDEA?

Sometimes we just don't have a CLUE (Late Middle English, "a ball of yarn or thread"). The now-obsolete term 'CLEW' was the ball of thread that Theseus, mythical king of Athens, used to guide himself out of the labyrinth in Crete (thanks to Ariadne, who gave it to him!). Its meaning of "that which points the way" dates from the 17th century.

A SKEIN (Old French, "hank of yarn") also works in some languages—such as Irish—as a 'clue'.

Being 'clueless' dates from the 1940s in the U.S., and it is still going strong!

'Skein' also refers to a flock of geese in flight (as opposed to a gaggle of geese on the ground, or perhaps a flotilla on water...).

Source "Captain Grammarpants". FB



Puzzler Answers

1. 13, 39, 48
2. Answer: 563412. All the other ticket numbers are combinations of the numbers 12, 34, and 56, and 563412 is the last possible combination of these numbers.
3. Wednesday
4. 5



Complementary Therapy for animals and people

We offer the following services:

- *Puppy, Rescue, Reactive & Dog 121 Training*
- *Reactive Dog Group Walks*
- *Dog Walking*
- *Pet Visits*
- *Group Walks*
- *Puppy and Dog Play & Social Sessions*
- *Animal Reiki & Healing Sessions*
- *Spiritual Healing Therapy Session*
- *Animal Assisted Therapy & Training Sessions*
- *Energy Clearance Sessions*
- *Meditation & Mindfulness Evenings*
- *Oracle & Tarot Card readings*

I am fully insured, DBS checked, qualified and pet first aid trained for all animal and healing services.

I use an enclosed field, based at Christchurch Community Centre and a Therapy Room.

For more information contact Emma on 07434 153002 or info@thewavelengthgroup.co.uk

<https://www.facebook.com/TheWavelengthGroup7>
<https://thewavelengthgroup.co.uk/>



Professional Massage Therapy in the comfort of your home.

Reflexology

Prenatal Massage

Swedish Massage

Deep Tissue Massage

Indian Head Massage

****We come to you!****



www.tryzenterapies.co.uk
tryzenhealth@outlook.com/07803327492

CHRISTCHURCH ELECTRICAL

Simon Freeland Hill Farm, 3 Church
Road, Christchurch, PE14 9PQ

Tel: 01354 638802 Mobile: 07727 046439



Domestic electrical work undertaken.
No job too small.
Free quotations / estimates.



www.electricalcompetentperson.co.uk

www.electricalsafetyregister.com



**ALL PESTS
CONTROLLED**

Domestic & Commercial Pest Control

www.allpestscontrolled.co.uk

WOODWORM

SQUIRRELS

BEDBUGS

RABBITS

MOLES

WASPS

MICE

BIRDS

RATS

FLEAS

ANTS

BEES



Call Danny on

Tel: 01945 772 153

Mob: 07795 073 985



A JONES & SON

TELEVISION SALES/REPAIRS/INSTALLATION

FREE LOCAL DELIVERY

FIRST CLASS AERIAL INSTALLATIONS/ADDITIONAL POINTS

26 March Road, Wimblington, March, Cambs PE15 0RN

Tel: 01354 740320

CLOSED ALL DAY TUESDAYS

FOUR SEASONS TREE SERVICES

Qualified & Professional Tree
and Client Care

PRUNING ● LOPPING ● FELLING

PLANTING ● REDUCING & RESHAPING

CROWN RAISING ● HEDGE TRIMMING

THINNING ● POLLARDING ● STUMP REMOVALS

OVERGROWN GARDENS PUT BACK INTO SHAPE

FRUIT TREES TREATED ● LOG & WOODCHIP SALES

FREE ESTIMATES & ADVICE WITH NO OBLIGATION

For quality jobs at a competitive price call:

Home: 01353 721665 - Mob: 07771 707921

All work carried out to BS 3998 Standard

A genuine family managed business est. for over 30 years - Fully Insured



THE NAME YOU CAN TRUST



This company offers a 7 day cooling off period



645 Services Ltd

For your complete Oil Services

Registered Office: 12/13 The Crescent, Wisbech,
Cambs PE13 1EH - Director: B E Easey
Company Registration Number: 07872493
VAT Number: 126 5422 30

For a competitive oil quote, for
delivery in the village and
surrounding area, (Outwell, Upwell,
Tipps End, Welney) please call 645
Services' local

Representative, Elaine, on 01354
638310 or 07803 178824

(office hours only please)

or Email: elaine@645services.co.uk

We will always try and be the best
price around - with local deliveries
scheduled for most weeks
throughout the month.

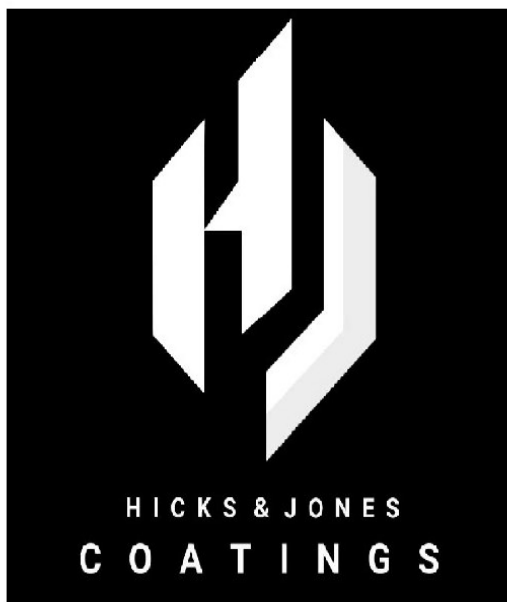

HICKS & JONES
COATINGS



Air/Airless Spray Painting

*Interior & Exterior Buildings. *uPVC Windows & Doors.
*Brick, Timber & Steel Structures. *End Of Lease Refresh.
*One Off Projects.

Call: 07703459675 / 07541266639

Email: hicksandjonescoatings@yahoo.com



Opening times:

Mon-Thurs 4pm-11pm
Friday 2pm-12am
Saturday 9am-12am
Sunday 12pm-11pm

Food available:

Monday Breakfast 9-11am
Tuesday 6-9pm
Fish Fridays 6-9pm (unless an event)
Saturday Breakfasts 9-11am
Saturday Pizza Night (unless an event)
Sunday Lunch 12:30-3pm

Forthcoming Events:

Sunday 3rd Sept 5pm - Sounds of Steel
Saturday 9th Sept 8pm till late - 60s night

A.R. CLINGO

FUNERAL DIRECTOR

Family Independant
Business

Private Chapel of Rest
Personal Attention

24 Hour Service

Full estimates given at all times

Golden Charter
Funeral Plans



Pinfold House
St. Peter's Road
Upwell, Wisbech
Phone 01945 772502



Paul Braybrooke

Oil Fired Boiler Engineer

**Boiler Servicing
& Breakdown Service**

Commissions

Tank Replacements

**Phone: 01353 777788
or 07946 735691**



Rehabilitation



Short & Long-term



Companionship



Dementia



Physical Disabilities



Discharge from Hospital

Wisbech, March, Downham Market



"I can only say that I was treated with care, patience and above all respect from each of your employees. They were polite at all times and very helpful - a credit to your company. I would recommend them to anyone."



Excellence



Partnership



Respect



Dignity



Integrity

In need of support for yourself or a loved one? Please get in touch with our dedicated team today...

careathome
BECAUSE HOME IS WHERE THE HEART IS



01945 773861



130 Wisbech Road, Outwell, PE14 8PF www.purehearthomecare.co.uk

Upwell Computer Repairs

Sales - Repairs - Maintenance - Upgrades

Sales & Support

Broadband Setup

Virus Removal

Tuition

Web Design

Email Setup

System Installations

Data Recovery Services



Laptop Screen Replacement

Windows Reinstallation

Hardware Upgrades

Software Upgrades

On-Site Services

Custom Built PC's

Internet Security

Network Installations



Contact Lewis today for a free consultation

Phone: 01945 772717 - 07849 778525

Email: support@upwellcomputerrepairs.co.uk

Web: www.upwellcomputerrepairs.co.uk

dermalogica®



Beauty Treatments by Jane

NVQ - op.i - Babtac.

Rose Cottage, Christchurch,
Cambs.

Telephone: 01354 638378



JESSICA®
Manicures & Pedicures



Microdermabrasion
Facials
& Gel Nails
& Pedicures



ST. TROPEZ
The Ultimate Tan

Non-surgical Face lifting Treatments



Qualified Seamstress

All dressmaking and sewing
jobs undertaken. Alterations
to clothing and curtains.

**Please contact: Sandra Kay
on 01354 638478**

SARAH JANE'S NURSERY

Mobile: 07905 368729

The Bungalow, Fifty Road, Manea, Cambridgeshire.
PE15 0HN

Sarah Cross

sarahjanesnursery@outlook.com

Also on Facebook

GRANARY STUDIO

Your local picture framer

01354 638614

www.granarystudio.uk

The Granary
Hall Farm, Upwell Road
Christchurch
PE14 9LJ



March Stationery & Print

Booklet Printing
Business Cards
Digital Photos
Leaflets
Newsletters
Banners

01354 656614

sales@marchsp.co.uk
5 Fenland Walk, March, PE15 8TW



LW Vehicle Services Ltd Car and Commercial Repairs

- Class 4 and 7 MOT Testing
- Full Diagnostic Service
- HGV Maintenance
- Batteries - Tyres - Exhausts
- Welding and Fabrication
- Timing Belts
- HGV PMI Inspections
- Aircon Service and Repair
- Courtesy Car Available
- All Service and Repairs Undertaken
- Car and Van Sales

Call **01354 610172**
Email lwvs@outlook.com
Web lwvehicleservices.com



March Road, Welney, PE14 9SE



Wisbech •FUNERAL SERVICE•

Independent Family Funeral Directors



Funeral Directors James
and Laura are proud to be
serving the community

Personal, caring & affordable

Advice without obligation

24 hours a day



FUNERALS FROM £2,495

Inclusive of all fees

Chapel of Rest

Traditional, Modern & Eco-friendly funerals
Pre-paid & pre-arranged funeral plans

17 Old Market, Wisbech, Cambridgeshire, PE13 1NB

01945 405950 (24hr)

www.wisbechfuneralservice.co.uk

WELLE CINEMA
Sunday 3rd September
Three Holes Village Hall
NO NEED TO BOOK

ELIZABETH
A Portrait in Part(s) 12a

To commemorate the 1st anniversary of the passing of Queen Elizabeth II, a unique and inventive feature documentary about the her life. A nostalgic, uplifting and fresh, modern chronicle of the extraordinary 70-year reign of Her Majesty the Queen, the longest-lived, longest-reigning British monarch and longest-serving female head of state in history.

Director—Roger Michell, Released April 2022

Starts 2pm doors open 1.30pm,
£3.50 pp.
BAR & REFRESHMENTS

For more details go to
www.threeholesvillagehall00.org.uk

 **creative**
 ARTS EAST

KATIES

GARDEN SERVICES

HOURLY & DAILY RATES AVAILABLE

- GRASS CUTTING
- WEEDING
- PLANTING
- CREATING NEW BORDERS
- SPRING/WINTER GENERAL GARDEN TIDY
- PATIO CLEANING
- PRUNING / TRIMMING
- REVIVING WOODEN GARDEN FURNITURE
- FENCE MAINTENANCE

KATIESGARDENSERVICES@GMAIL.COM
TEL.07929 005347

Outwell Timber

For all your Timber and Building Supplies

ISLE ROAD, OUTWELL
 PE14 8TD
 Tel: 01945 77 21 16

FENCING, PANELS, TRELLIS
 TIMBER, PLYWOOD, DECKING

SAND, BALLAST, GRAVEL

SCREWS, NAILS, BOLTS

PAINT, SILICONE, HAND TOOLS

LOCKS, ELECTRICALS, PLUMBING,
 GUTTERING

UNDERGROUND PIPE & FITTINGS

CEMENT, MULTIFINISH, PLASTERBOARD

Russell's Family
Butchers

Family butchers for 5 generations.
All of our meat and poultry is fresh
free range from our own farm.

Visit us at our shop in Upwell or at
our market stall in March
(Saturdays) or Wisbech
(Thursdays and Saturdays).

97 School Road, Upwell,
PE15 9EW
Tel: 01945 773419

Magenta: The colour that doesn't exist...and why

I am sure you recognize magenta — it's that colour that's a mix between purple and red. It's sort of pinkish-purple, and looks something like this:



That would be all well and good, except there's a little problem with the statement above: on the spectrum of light, the colour(s) between purple and red are as follows: yellow, green, blue, orange... etc. Instead, magenta manifests itself on the aptly-named colour wheel, which illustrates colours fading into one another. Red and purple are the two ends of the spectrum, so on the colour wheel, they naturally fade into one another.



So, if it doesn't exist, why can we see it? Again, on the spectrum of elements, all visible colours (and non-visible rays) have specific wavelengths which distinguish them from the other colours on the colour wheel. Magenta, because it doesn't exist on the light spectrum, doesn't have one. Rather, it's something our brain creates to fill in space in a way that makes sense.



Usually, when trying to determine colour, the brain simply averages the colours to come up with an outcome. If you mix green and red light, you'll end up with a yellow light because the brain has averaged it. When you mix red and purple light, your brain averages them. Ultimately, this would reasonably come out to green - that's the average wavelength - but because your brain wants the outcome to make logical sense, it mixes the colours and you get magenta.



How does the human eye detect the colour magenta?

Magenta doesn't exist because it has no wavelength; there's no place for it on the spectrum. The only reason we see it is because our brain doesn't like having green (magenta's complement) between purple and red, so it substitutes a new thing.

Source: <https://medium.com>

How were the fens drained?

Who drained the fens?

A long time ago, the fens were watery marshes. They were wild, dangerous places filled with tall grasses and flat wetlands. There were also areas, or islands, of high land in the fens. Ely is sometimes known as The Isle of Ely because it was built on an island of solid ground surrounded by the marsh.

Around 400 years ago, life changed dramatically when the fens were drained. The Dutch engineer Cornelius Vermuyden was asked by King Charles I to design a plan to turn the wetlands into farmland. In 1630 the Old Bedford River was dug in a straight line from Earith to Denver, channelling the water from the fen towards the sea.

The plans to drain the wetlands were paid for by a group of wealthy men, known as the 'Gentleman Adventurers', who were led by the Earl of Bedford. They were given acres of the new, drained farmland in return for their investment.

They drained the fens by straightening meandering rivers, building embankments and sluices, a type of channel for water which is controlled by gates, to keep the tides out. They created washes to store the flood waters, such as the Ouse Wash reservoir which is the 3rd largest in England.

Local people, who relied on the wild fen for hunting and fishing, rebelled against the loss of their livelihoods. They smashed dams and destroyed dykes and became known as the 'Fen Tigers'.

The process of draining the fens was very difficult because when the land was drained of water, the peat soil found in the fens shrank. Once the land in the fields were lower than the surrounding rivers, flooding became common for hundreds of years as water overflowed the new earth banks.

By the end of the 17th century, the fenlands looked totally different, with long straight channels and regular angles where wild wetlands and meandering streams had once been.

Draining the fens took hundreds of years, and it is still an ongoing process today. The landscape is managed with drainage channels and pumps, which keep the water under control so that the rich peat soil can be used to grow a wide range of crops.



Source: Ely Museum
Part 1 of 3

Any views expressed in The Heron do not necessarily reflect the views of The Heron Editorial Team. The team aim to provide a balanced view of village opinions where such views are expressed. We reserve the right to edit any submissions where we feel this is appropriate.



The Heron is printed by
March Stationery & Print, 5 Fenland Walk, March, Cambs PE15 8TW
Tel: 01354 656614 Email: sales@marchsp.co.uk